



## Ridges 66 - 572 Sugar Creek Hollow

Welcome to the Artisan House. Custom craftsmanship is the hallmark of this home with furniture-grade finishes, cabinetry, and built-ins. This wood-lover's hideaway along Sugar Creek features some of the finest woods including mahogany, quarter and rift sawn white oak, hemlock, cedar, and ipe; all handpicked for grain, color, and figure. The lower yard offers a sheltered spot for seating or lawn activities with views of the creek. The home is conveniently located central to The Greenbrier and Sporting Club amenities.

THE *Greenbrier*  
SINCE 1778  
SPORTING  
CLUB®

5 Kate's Mountain Road  
White Sulphur Springs, WV 24986  
855-764-7398

Discover *Life as Few Know It* by visiting [greenbrierliving.com](http://greenbrierliving.com) | 855-764-7398





### Stunning Entry

The arched, paneled entry is symbolic of the materials chosen for this home. Each figured mahogany panel is symmetrically book-matched with a hand-brushed finish to furniture-grade. Antique glass in the entry door completes the transition from outside in.

*Foyer Dimensions: 16'7" x 16'7" = 275 SF*



### Gourmet Kitchen

This nationally award-winning gourmet kitchen is peerless in its heirloom quality craftsmanship. The kitchen furniture and cabinetry are made from one highly figured, rare mahogany log. Top-shelf details abound with hand-cut exposed dovetails, the finest hardware, professional grade appliances, granite countertops, and hand-hammered copper, apron-front farmhouse sinks.

*Kitchen Dimensions: 19'7" x 14'7" = 286 SF*



### Great Room

A focal point in the great room is the stone fireplace with built-in custom cabinetry at both sides. Pre-wired for A/V control and speakers, the entertainment center has a remote control panel above the mantle. Soffit up-lighting allows the twilight ambiance to showcase views through the vast window to the woods and creek outside.

*Great Room Dimensions: 20'5" x 14' = 286 SF*



### Master Suite

The luxurious master bedroom features a stone fireplace, access to the study, beeswing mahogany armoire, and a small patio with private creek views. Relaxation is inevitable in the soaking tub with private, wooded views. The master bath also features his and her vanities, walk-in limestone shower, hand-hammered bronze towel bars, and heated limestone floors.

*Master Suite Dimensions : 15'3" x 18'9" plus 7' x 13' = 377 SF*

Main Level



Upper Level



Garage

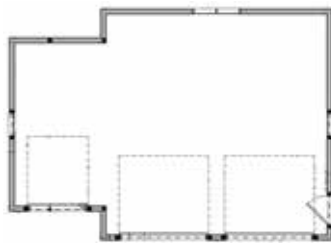

# Features

4-5 Bedrooms & 5 Full Bathrooms  
 Views Wooded, Mountain, and Creekside  
 Builder Corlis Design & Construction  
 Year Built 2005  
 Architect McConnell & Ewing Architects  
 Square Footage 3,818 Heated (5,318 Total)

## Exterior Features

- Cedar Shake Roof
- Western Red Cedar Wood Siding
- 2-car Garage (791 SF)
- Covered Front Porch and Side Porch Adjacent to Kitchen
- Over 1,500 SF of Stone Terraces and Ipe Decking
- Architecturally Coordinated Doghouse

## Interior Features

- Quarter Sawn Oak Wood Flooring Throughout
- Handpicked Mahogany Throughout Interior, Unique to This Home
- Built-in Bookshelves & Reading Bench
- Upper Level Balcony Overlooking Living Room
- 2-story Vaulted Ceiling in Living Room
- 2 Stone Fireplaces
- Custom-Made Cabinetry: Signature Woodworks by Corlis Design
- G.E. Monogram Series Appliances
- Granite Countertops in Kitchen
- Unique "Rainforest" Granite Counters & Surround Tub in Master Bath
- Radiant Heating in Lower Level Bathrooms
- Additional Room Dimensions:

Dining Room: 15'10" x 14' = 222 SF  
 Guest Bedroom 2: 15'10" x 18'9" = 297 SF  
 Guest Bedroom 3: 15'3" x 18'9" = 286 SF  
 Guest Bedroom 4: 13'5" x 11'9" = 158 SF





**The exclusive private residential community at The Greenbrier**



855-764-7398

[home@greenbrierliving.com](mailto:home@greenbrierliving.com)

[greenbrierliving.com](http://greenbrierliving.com)

- An award-winning golf course, The Snead – an 18-hole Tom Fazio-designed golf course
- Eastern-inspired spa, Ananda in the Alleghenies
- Full-service equestrian center with boarding option
- Sports complex with infinity pool
- Indoor squash courts
- 25-foot climbing wall
- An exclusive mountaintop lodge, The Summit, with Activities Barn offering basketball/volleyball courts and infinity pool, outdoor amphitheater, mini-golf and play ground
- Access to over 20 miles of hiking and biking trails
- Members enjoy complete access to the 55 activities and amenities at The Greenbrier resort, including three championship golf courses: The Old White TPC, The Greenbrier, and The Meadows.



Download our app at  
**GSCAPP.COM** 

Obtain the Property Report as required by Federal law and read it before signing anything. No Federal Agency has judged the merits or value, if any, of this property. This is not intended to be an offer to sell nor a solicitation of offers to buy real estate in Greenbrier Sporting Club by residents of Hawaii, Idaho, Illinois, and Oregon or in any other jurisdiction where prohibited by law. This project is registered with the New Jersey Real Estate Commission, N.J. Reg. No. 11-59-0002. This project is registered in pursuant to New York State Department of Law's simplified procedure for Homeowners Associations with a De Minimus Cooperative Interest and contained in a CPS-7 application available from the sponsor. File No. HO-00-0082. This project is registered with the Pennsylvania State Real Estate Commission, Registration No. OL-000654. Use of recreational facilities and amenities requires a separate club membership. Plans, renderings, designs, dimensions, specifications, material and other depictions, as well as the number, type, availability, location, appearance and pricing of lots and homes are subject to change without notice. Illustrations are artists' depictions only and may differ from completed improvements. We are pledged to the letter and spirit of U.S. policy for the achievement of equal housing opportunity throughout the nation. We encourage and support an affirmative advertising and marketing program in which there are no barriers to obtaining housing because of race, color, religion, sex, handicap, familial status or national origin.