



LODGE COTTAGE 6 - 531 SPORTING CLUB DRIVE

This stunning golf course retreat, situated on The Greenbrier's championship golf course, The Meadows, is mere steps from several exclusive Sporting Club amenities, including the Members' Lodge, Sports Complex, Ananda Spa & The Snead, a Tom Fazio-designed golf course. Conveniently located for the member who wants to be in the center of it all, surrounded by gorgeous views, especially from the stone patio that overlooks the 14th green of The Meadows and the Allegheny Mountains beyond.

Greenbrier
LIVING

(855) 764-7398
GreenbrierLiving.com



GREAT ROOM

Architectural details abound throughout this rustic, yet elegant styled home. The spacious great room boasts a dramatic, vaulted wood ceiling with timber beams, a stacked stone fireplace and direct porch and patio access.

Great Room Dimensions: 24' x 19'6" = 468 SF



KITCHEN

The open floor plan allows for easy entertaining as the gourmet kitchen flows into the dining room and on into the great room. Features include a convenient center island, granite countertops, Jay Rambo cabinetry and GE appliances. Access to the bonus/guest room, above the garage, sits off from the kitchen through the mud room.

Kitchen Dimensions: 10'10" x 16' = 173 SF



MASTER SUITE

The master suite includes a fireplace, access to a rear screened-in porch, dual walk-in closets, his and her baths with heated limestone floors that are connected by a custom stone shower.

Master Bedroom Dimensions: 16'6" x 19' = 314 SF



GUEST SUITES

The second floor is the ultimate guest retreat with three guest suites, as well as a sun room/study that boasts French door access to a balcony overlooking The Lodge and a sleeper sofa that converts to a double bed. The third bonus/guest room is found above the garage with plenty of natural light from the center cupola and can easily access the mudroom, laundry room and full bath below.

Upper Level Guest Bedroom Dimensions: 13' x 20' = 260 SF

FEATURES

4 Bedrooms & 4 ½ Bathrooms

Views Fairway & Mountain

Architect Hart Howerton

Builder Pinnacle Group

Year Built 2004

Landscape Architect Hart Howerton

Square Footage 4,425 Heated, 5,656 Total

Part of Optional Rental Program

Exterior Features

- Close Proximity to Members' Lodge
- 2-Car Attached Garage
- Board and Batten & Western Red Cedar Wood Siding
- Cedar Shake Roof
- Front Porch
- Stone Patio

Interior Features

- Home Furnishings Included
- Oak Floors
- Two Stone Gas Fireplaces
- Vaulted Cedar Ceiling & Timber Beams
- Built-In Book Shelves
- Jay Rambo Cabinetry
- GE Monogram Appliances
- Kohler Fixtures
- Granite Countertops
- Security System
- Two Screened-In Porches with Ceiling Fans
- Additional Room Dimensions (Approx.):
 - Sun Room: 12' x 19'6" = 234 SF
 - Study: 15' x 13' = 195 SF
 - Guest Bedroom: 16' x 20' = 320 SF
 - Bonus/Bedroom Above Garage

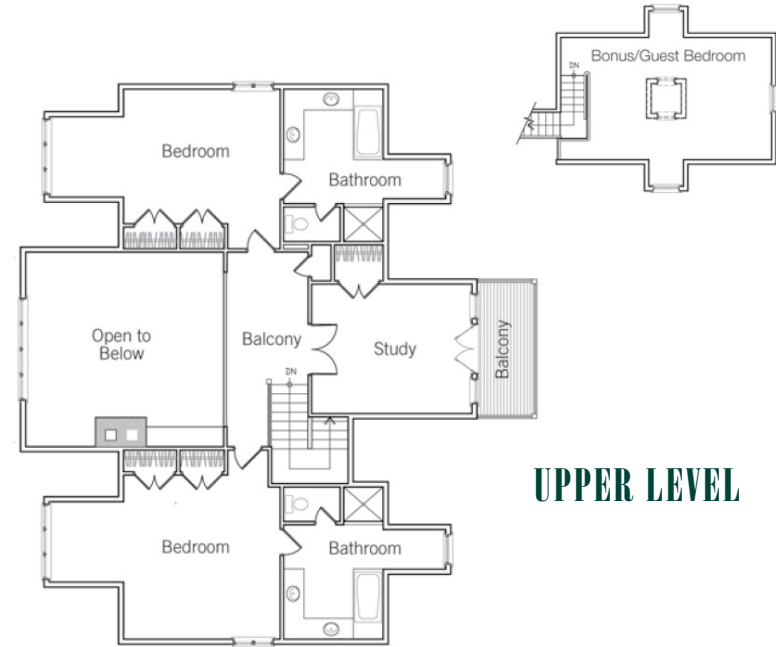

UPPER LEVEL

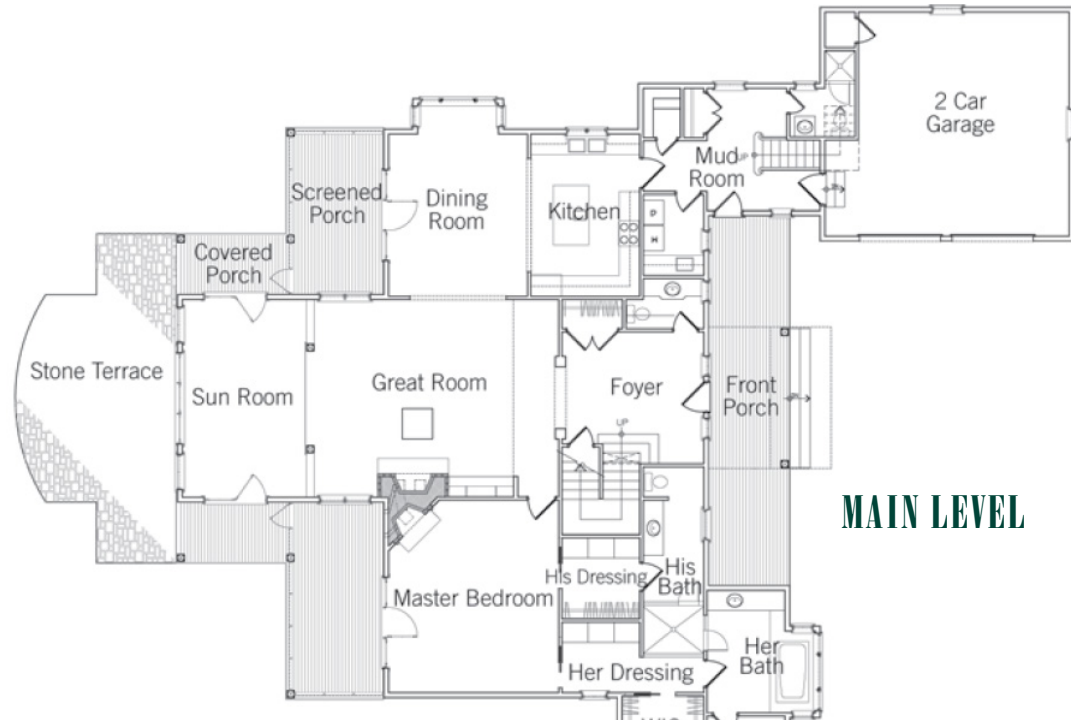

MAIN LEVEL



(855) 764-7398 • GreenbrierLiving.com
John Klemish, Broker-in-Charge
Real Estate Showroom located in the Lower Lobby

Real Estate at America's Resort™



Obtain the Property Report required by Federal law and read it before signing anything. No Federal Agency has judged the merits or value, if any, of this property. This is not intended to be an offer to sell nor a solicitation of offers to buy real estate in The Greenbrier Sporting Club by residents of Hawaii, Idaho, Illinois, and Oregon or in any other jurisdiction where prohibited by law. This project is registered with the New Jersey Real Estate Commission, N.J. Reg. No. 11-59-0002. This project is registered pursuant to New York State Department of Law's simplified procedure for Homeowners Associations with a De Minimus Cooperative Interest and contained in a CPS-7 application available from the sponsor. File No. HO-00-0082. This project is registered with the Pennsylvania State Real Estate Commission, Registration No. OL-000654. Use of recreational facilities and amenities requires separate club membership.



© 2021 The Greenbrier Sporting Club / 5 Kate's Mountain Road, White Sulphur Springs, WV 24986